

NOTE: DIMENSIONS IN [ ] ARE ENGLISH EQUIVALENTS.

REV	DATE	REVISION	BY	UNLESS OTHERWISE SPECIFIED - 1) DIMENSIONS ARE IN MILLIMETERS 2) TOLERANCE ARE: 2.XX ± 0.25 2.4 ± 0.15 ANGLES ± 0° 30' / MAX.	TITLE
-	8-20-04	NEW DRAWING [72925]	MRS		<b>KOHLER CO. METRIC PRO-E</b> POWER SYSTEMS, KOHLER, WI 53044 U.S.A. THIS DRAWING IN DESIGN AND DETAIL IS KOHLER CO. PROPERTY AND MUST NOT BE USED EXCEPT IN CONNECTION WITH KOHLER CO. WORK. ALL RIGHTS OF DESIGN OR INVENTION ARE RESERVED.
A	9-24-04	(A-1) SHEET 1 OF 4 WAS 1 OF 3; (C-2) MOUNTING PAD DETAIL ADDED; [73405]	BTW		
APPROVALS		DATE	SCALE 0.2X CAD NO. SHEET 1 of 4		
DRAWN		MRS 8-20-04	DWG NO. <b>ADV-7000</b>		
CHECKED		JMS 8-24-04	D		
APPROVED		AJB 8-25-04			

15-30 RES

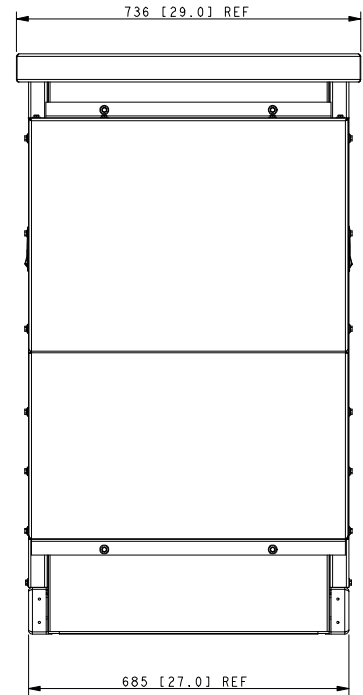
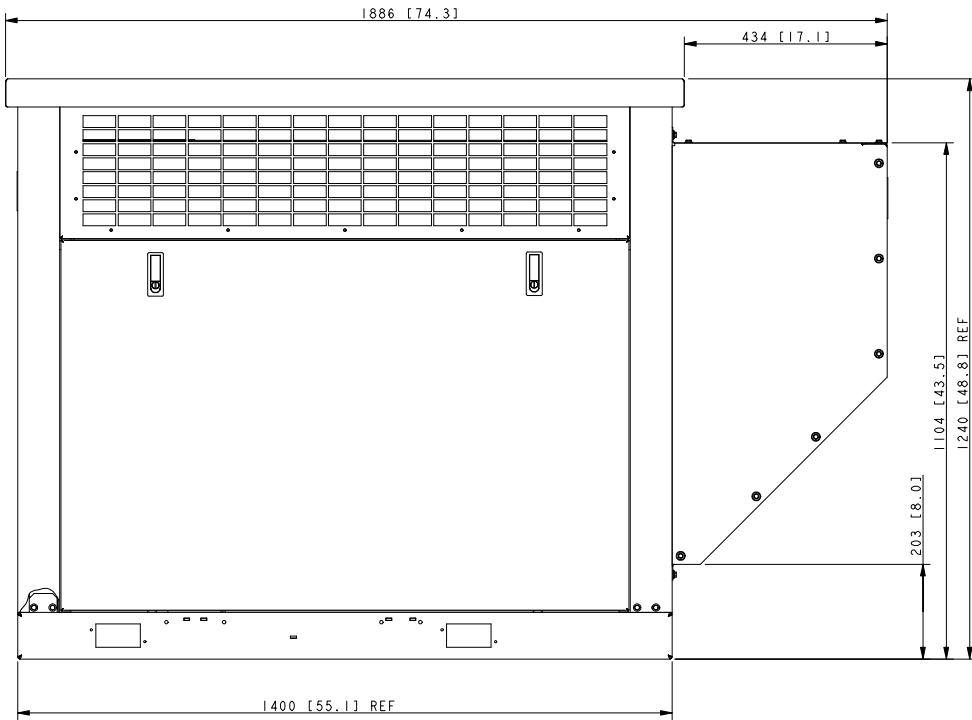

**SOUND ATTENUATED WEATHER HOUSING  
(WEATHER HOUSING W/ SOUND UPFLT)**

NOTES:  
DIMENSIONS IN [ ] ARE IN INCH EQUIVALENTS.

15 RES

REV	DATE	REVISION	BY	UNLESS OTHERWISE SPECIFIED - 1) DIMENSIONS ARE IN MILLIMETERS 2) TOLERANCES ARE:	<b>KOHLER CO. METRIC PRO-E</b> <small>POWER SYSTEMS, KOHLER, WI 53044 U.S.A.</small> <small>THIS DRAWING IN DESIGN AND DETAIL IS KOHLER CO. PROPERTY AND MUST NOT BE USED EXCEPT IN CONNECTION WITH KOHLER CO. WORK. ALL RIGHTS OF DESIGN OR INVENTION ARE RESERVED.</small>
-	8-20-04	NEW DRAWING [72925]	MRS	2.XX ± 0.25	
A	9-24-04	SOUND & WEATHER HOUSING VIEW ADDED, SHEET 2 OF 4 WAS 2 OF 3 & VIEWS FROM SHEET 2 MOVED TO SHEET 3; [73405]	BTW	2.4 ± 0.15 SURFACE FINISH ANGLES ± 0° 30' / MAX.	
					<small>TITLED</small> <small>APPROVALS</small> <small>DATE</small> <small>DRAWN</small> MRS 8-20-04 <small>CHECKED</small> JMS 8-24-04 <small>APPROVED</small> A.J.B 8-25-04
					<small>SCALE</small> .2X <small>CAD NO.</small> <small>DWG NO.</small> <b>ADV-7000</b> <small>SHEET 2 of 4</small> <b>D</b>

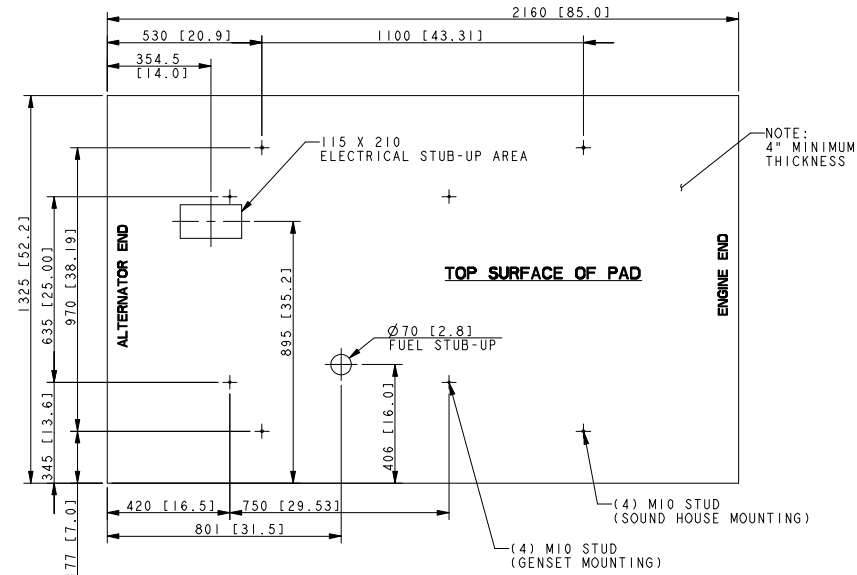
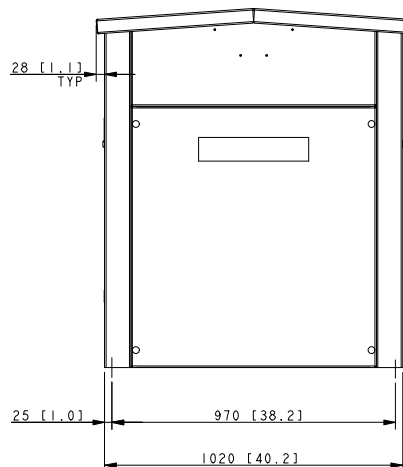
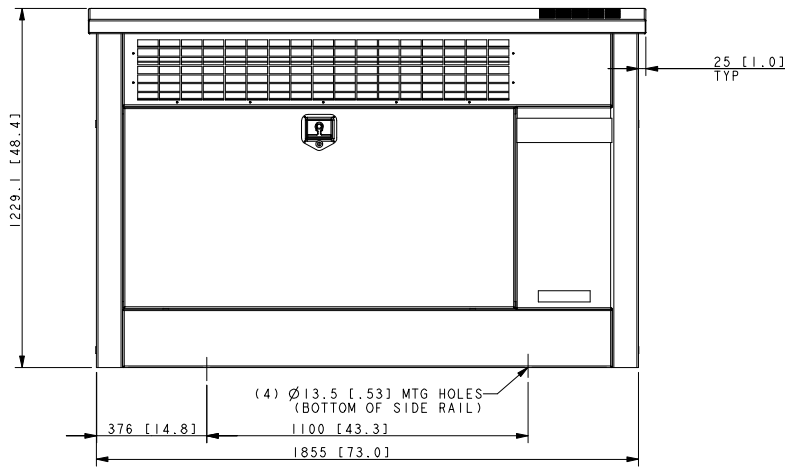
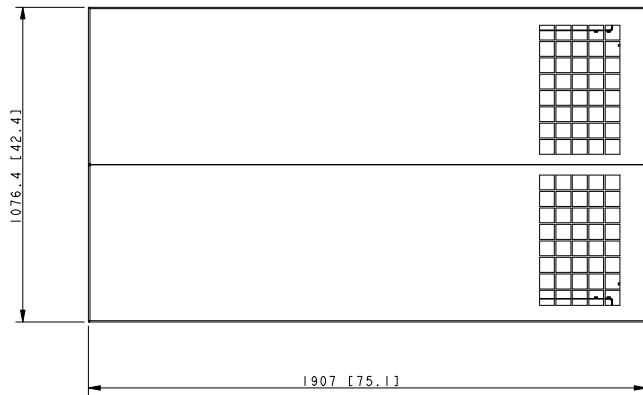

**SOUND HOUSING**

REV	DATE	REVISION	BY	UNLESS OTHERWISE SPECIFIED - 1) DIMENSIONS ARE IN MILLIMETERS 2) TOLERANCES ARE: 2.XX ± 0.25 X.X ± 1.5 ANGLES ± 0° 30' / MAX.	TITLE
-	8-2-04	NEW DRAWING. [72925]	MRS		<b>KOHLER CO. METRIC PRO-E</b> POWER SYSTEMS, KOHLER, WI 53044 U.S.A. THIS DRAWING IN DESIGN AND DETAIL IS KOHLER CO. PROPERTY AND MUST NOT BE USED EXCEPT IN CONNECTION WITH KOHLER CO. WORK. ALL RIGHTS OF DESIGN OR INVENTION ARE RESERVED. <b>DIMENSION PRINT</b>
A	9-24-04	(A-1) SHEET 3 OF 4 WAS 3 OF 3, VIEWS ADDED FROM SHEET 2 & INSTALLATION GUIDE VIEWS MOVED TO SHEET 4: [73405]	BTW		
			BTW		
APPROVALS		DATE	SCALE: 1:25X CAD NO. SHEET 3 of 4		
DRAWN		MRS 8-20-04	ADV-7000 D		
CHECKED		JMS 8-24-04			
APPROVED		AJB 8-25-04			

15-30 RES

# RESIDENTIAL INSTALLATION GUIDE

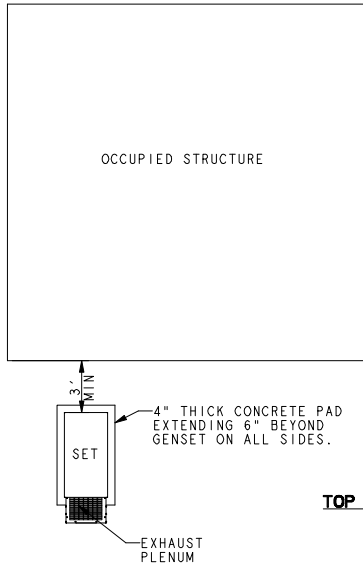

**TOP VIEW**

**PREFERRED**

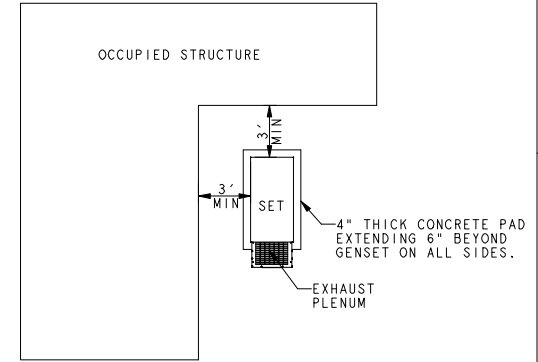
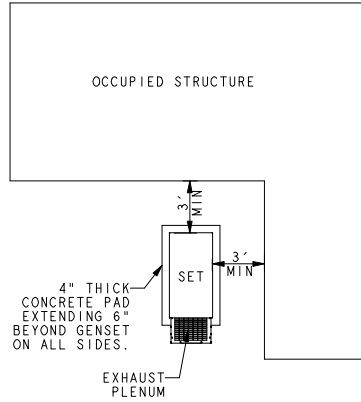

**TOP VIEW**

**ACCEPTABLE**

- 1) EXHAUST END IS AWAY FROM THE STRUCTURE.
- 2) EXHAUST IS NOT DIRECTED AT PLAY AREAS, PATIOS, UNDER OVERHANGS OR AREAS WHERE PEOPLE CONGREGATE.
- 3) THE NEAREST WINDOW, VENT, DOOR OR SIMILAR STRUCTURE OPENING IS AT LEAST 5' FROM THE EXHAUST END OF THE SET.
- 4) SET HAS PROPER OFFSET FROM STRUCTURE.
- 5) WINDOWS & DOORS ON ADJACENT WALLS ARE CLOSED.
- 6) FURNACE AND OTHER SIMILAR INTAKES ARE AT LEAST 10' FROM EXHAUST END OF SET.
- 7) REFER TO OWNERS MANUAL FOR OTHER INSTALLATION CONSTRAINTS.

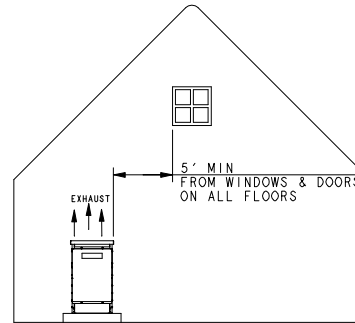

**FRONT ELEVATION VIEW**

- 1) EXHAUST IS AWAY OR PARALLEL TO STRUCTURE.
- 2) EXHAUST IS NOT DIRECTED AT PLAY AREAS, PATIOS, UNDER OVERHANGS OR AREAS WHERE PEOPLE CONGREGATE.
- 3) THE NEAREST WINDOW, VENT, DOOR OR SIMILAR STRUCTURE OPENING IS AT LEAST 5' FROM THE EXHAUST END OF THE SET.
- 4) SET HAS PROPER OFFSET FROM STRUCTURE.
- 5) WINDOWS & DOORS ON ADJACENT WALLS ARE CLOSED.
- 6) FURNACE AND OTHER SIMILAR INTAKES ARE AT LEAST 10' FROM EXHAUST END OF SET.
- 7) REFER TO OWNERS MANUAL FOR OTHER INSTALLATION CONSTRAINTS.

REV	DATE	REVISION	BY	UNLESS OTHERWISE SPECIFIED - 1) DIMENSIONS ARE IN MILLIMETERS 2) TOLERANCES ARE: 2. XX ± 0.25 2. Y ± 1.5 ANGLES ± 0° 30' / MAX.	APPROVALS	DATE	TITLE
A	9-24-04	(A-1) SHEET 4 ADDED & INSTALLATION GUIDE VIEWS ADDED FROM SHEET 3; [73405]	BTW	1) DIMENSIONS ARE IN MILLIMETERS 2) TOLERANCES ARE: 2. XX ± 0.25 2. Y ± 1.5 ANGLES ± 0° 30' / MAX.		9-24-04	<b>KOHLER CO. METRIC PRO-E</b> POWER SYSTEMS, KOHLER, WI 53044 U.S.A. THIS DRAWING IN DESIGN AND DETAIL IS KOHLER CO. PROPERTY AND MUST NOT BE USED EXCEPT IN CONNECTION WITH KOHLER CO. WORK. ALL RIGHTS OF DESIGN OR INVENTION ARE RESERVED.
							<b>DIMENSION PRINT</b>
							SCALE: 1/25X CAD NO. SHEET 4 of 4
							ADV-7000 D